

Maritimo Price List - EX241-2

## M60 FLYBRIDGE MOTOR YACHT - Black Edition



*Maritimo*®

M60 FLYBRIDGE MOTOR YACHT

Pricing effective between 2-Sep-2024 to 28-Jun-2025

All prices in Australian Dollars

Client:

Date:

Address:

Boat #:

Sales Agent:

STARTING BOAT PRICE (AUS)

AU \$4,119,500

LENGTH OVERALL	18.53 M	60' 10" FT
HULL LENGTH ISO	18.34 M	60' 2" FT
BEAM	5.220 M	17' 2" FT
DRAFT (subject to fitout and load conditions)	1.523 M	5' 0" FT
DRY WEIGHT (subject to fitout and load conditions)	33,600 KG	74,075 LBS
FUEL CAPACITY	4,550 L	1,200 US GAL
WATER CAPACITY	700 L	185 US GAL
HOLDING TANK CAPACITY	300 L	79 US GAL
SLEEPING CABINS	3 STANDARD	
SLEEPING CAPACITY	6 STANDARD	
ENGINES	2 X VOLVO D13 - 800 MHP TD	
GENERATOR		17.5 kW 50 HZ

DISCLAIMER | 1 YEAR WARRANTY – 5 YEAR STRUCTURAL

The information contained in this product specification document inclusive of drawings is a guide only and Maritimo and all its' associated entities (Maritimo) will not be held liable for any loss suffered, due to inaccuracy of the information contained in this document by any individual, partnership, corporation and their predecessors, successor, assigns. etc. that solely rely on this information as a basis to make their decisions whether in contract, tort or otherwise. Maritimo reserves the right to change these specifications subject to any reason and at any time it determines, including but not limited to foreign currency exchange rate fluctuations and product availability.



# PLANS

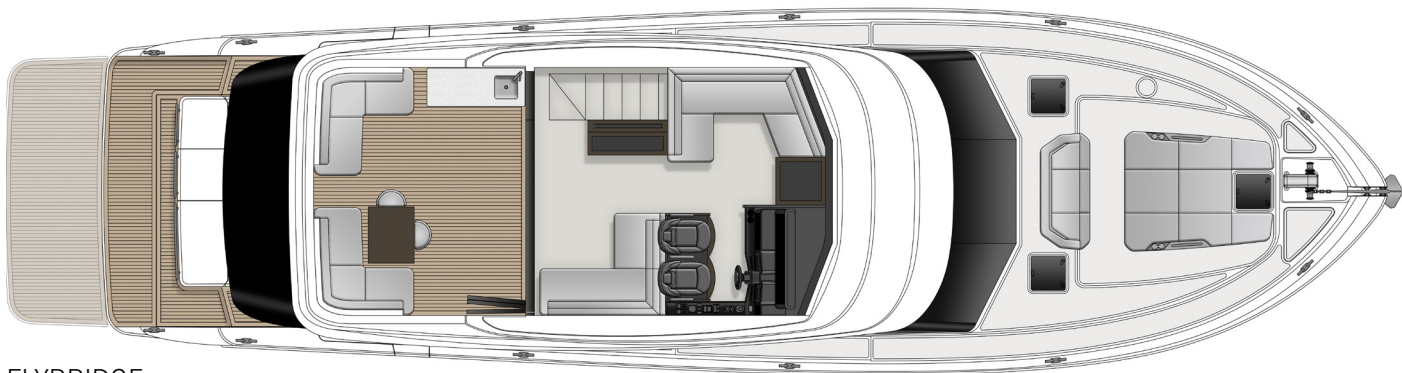

FLYBRIDGE

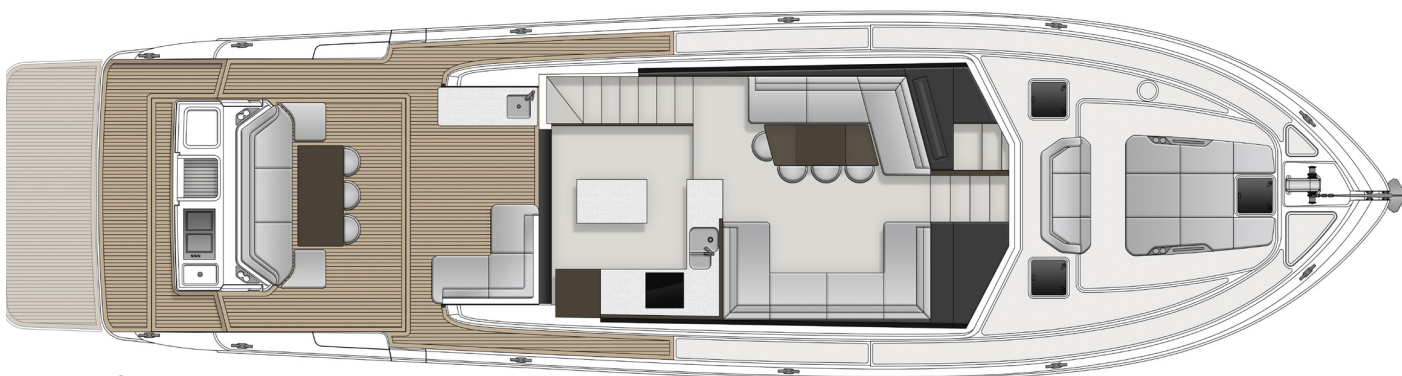

MAIN DECK

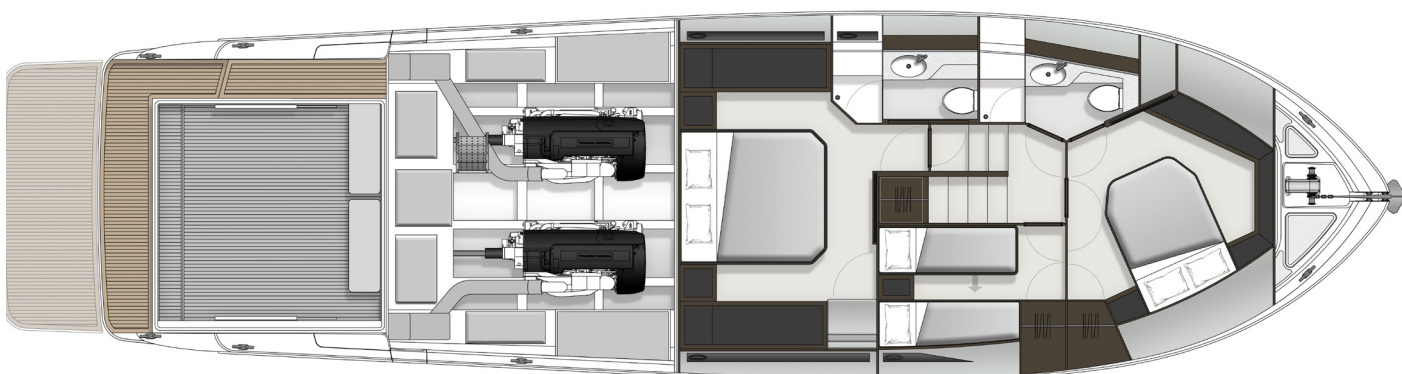

LOWER DECK

Note: plans may be shown with some optional features

---

# STANDARD SPECIFICATIONS

---

## AIR CONDITIONING

- Air conditioning to flybridge 2 x 16,000 BTU
- Air conditioning to saloon 2 x 12,000 BTU
- Air conditioning to master stateroom 1 x 12,000 BTU
- Air conditioning to forward stateroom, split to starboard cabin 1 x 12,000 BTU
- Air conditioning to bathrooms
- Air conditioning - windscreen demist

## HULL TECHNOLOGY

- Deck and wheelhouse – fibreglass with core
- Flybridge – fibreglass with core
- Fuel tanks integral GRP
- Fully integrated structural hull liner with patented bonding process (GRP)
- Hull - solid fibreglass
- Hull anti-foul (not covered by 5 year structural warranty)
- Main bulkheads free standing fibreglass with core
- Propspeed to propellers, rudder & drive line
- Variable dead rise deep V hull with moulded spray rails
- Water tight collision bulkheads

## ENGINEERING

- Acoustic sound insulation
- Ball valves and skin fittings 316 stainless steel below water line
- Bilge pumps - auto - 6 x 1600 GPH
- Controls – single lever electronic single station
- Engine bearers – moulded solid fibreglass
- Engine exhaust risers and aqualift mufflers, water separator to generator with side exit
- Engine instruments – electronic single station
- Engine room air extraction
- Engine room air intake washable filters
- Engine room fire system auto / manual
- Engine room lighting AC off inverter
- External and internal strainers fitted to water intakes
- Flexible engine mounts
- Fresh water heater (AC only) – quick recovery
- Fresh water pump fitted with accumulator tank
- Fresh water tank and separate water filter for galley
- Fresh water tap in engine room
- Fuel filters – primary filters for each main engine and generator
- Fuel lines – approved rubber. All fittings swaged
- Fuel tanks (GRP) with sight gauge
- King Starboard floor between engines
- Lazarette ventilation
- Power steering – Tiller system with emergency locking pins
- Propellers computer machined Nibral 5 blade
- Rudders and bronze struts
- Shaft seals - dripless, with spare seals
- Shafts – 2 ¼” duplex – stainless steel
- Smoke detectors x 5, master and fwd staterooms, stb cabin, saloon and flybridge
- Thruster – bow and stern thruster incl. hand held remote
- Toilet holding tank
- Trim tabs – hydraulic

## ELECTRICAL

- Batteries House - house bank - 4 x 200 Ah
- Batteries Start - 2 x port, 2 x starboard start - 900cca
- Battery charging: inverter charger 4 kW - 100 Amp charger
- Battery switching - dedicated engine batteries isolate each engine
- Paralleling switches link systems for starting and charging
- Bonding system - 1 x large anode. Tinned bonding wire to skin fittings and heavy bonding between main engines and generator
- Earthing - RCD fitted to all sub circuits. Polarity warning device on shore power and power points - 1 x galley, 1 x master cabin, 1 x forward cabin, 1 x flybridge, 1 x wet bar
- Electrical panels - dedicated DC panels for accommodation deck and flybridge. Load sharing AC panels
- Electrical wiring - tinned wiring where applicable coded and labeled
- Fuel gauge to electrical panel
- Generator fitted with sound shield and 24 volt charging alternator with water separator to exhaust
- Inverter supplies multiple power points, fridge, TVs and stereos
- Navigation lights
- Self contained fire suppression system to electrical panel
- Solenoid pack for auto pilot
- Vimar AC outlet / USB charger to master & forward staterooms x 2, starboard cabin x 1, helm x 1, galley x 1 and saloon x 1
- Water gauge at electrical panel

## MAIN DECK

- Anchor - self stowing 40kg stainless steel anchor with 60 metres of 10mm chain and heavy duty bow roller self loading
- Black - upper and lower fwd window mullions
- Bow stowage locker with freshwater tap
- Electric horn
- Finish - forward side decks and trunk cabin in non skid GRP
- Fuel filler on port and starboard sides
- Hatches x 3 - escape hatches including roller blinds
- LED lights to boarding steps and external walk around steps port & stbd (total 6)
- Rails - stainless steel, bow and grab rails
- Stainless steel cleats bow, spring and stern – total 10
- Sullage pump out situated in cockpit coaming
- White PVC high-impact rubbing banding with stainless-steel insert
- Winch - Muir Jaguar, reversible 24 volt heavy duty horizontal winch with fore deck and flybridge controls

---

# STANDARD SPECIFICATIONS

---

## FLYBRIDGE

- AC and DC control panel
- Access - internal staircase from salon
- Awning (white) to rear flybridge hardtop
- Balcony bar module - **Black Edition** two door wet bar to port side includes; sink, rubbish bin, Solidsurface top and storage (can option a bar fridge)
- Deck hatches x 4 (2 x forward interior with blinds and 2 x exterior)
- Doors - bi-fold glass doors, full width **Black Edition**, leading to balcony
- Drink holders x 2 on console
- Internal entertainment unit
- Flooring internal - wool carpet (Action Back - Stone)
- Flooring external - GRP non skid
- Lounge - forward cruising in Contemporary Style
- Lounge - aft entertainment in Contemporary Style
- Helm seat x 2 - **Black Edition** - electric up/down, fore/aft, recline and heating on timber box with footrests
- Helm station - **Black Edition** design - fully equipped with steering, engine controls, engine instrumentation, bow and stern thruster control, trim tab controls, winch up/down controls, compass, 1 x navigation down light
- LED ceiling lights
- Mounting positions for optional navigation dome / radar
- Muir chain counter readout only
- Rear flybridge rail - stainless with GRP moulded rail Panavision infill
- Search spotlight with remote control
- Side table - **Black Edition** forward cruising lounge side table with drawer
- Windows - fixed tinted and toughened glass
- Windscreen wiper and washer x 3 with intermittent wiper control

## GALLEY

- Bench tops - solidsurface
- Dishwasher - dish drawer under cook top
- Doors - sliding glass doors leading to cockpit
- Drawers for plates, cutlery and pans etc
- Flooring - Karndean
- Galley overhead cupboards to starboard side (**Black Edition Design**)
- Galley splashback to be Solidsurface and galley island bench to have Solidsurface waterfalls (**Black Edition Design**)
- Ice maker and storage to port side
- Island bench with solidsurface top and cupboards below
- LED ceiling lights
- Pantry - slide out
- Premium Cook Top - 4 burner
- Premium Combination Microwave Oven
- Premium Refrigerator / Freezer - 2 Door (AC)
- Rangehood
- Rubbish receptacle
- Sink and tap - **Black Edition** - stainless steel twin sink with new pull out mixer tap and cupboard below

## SALOON

- Blinds - Shangri La Silhouette roller blinds to side windows and aft doors
- Cabinet - **Black Edition** glasses cabinet to fwd galley
- Cabinet - **Black Edition** liquer cabinet to base of stairs
- Dinette table - table on fixed pedestal to port
- Flooring - wool carpet (Action Back - Stone)
- Internal staircase to flybridge
- Lounge - U-shaped, leather upholstered, starboard
- Lounge - L-shaped, leather upholstered, port
- Lounges in Contemporary Style
- LED ceiling lights
- Windows - fixed tinted and toughened glass

## MASTER STATEROOM

- Bed - king size island berth with inner spring mattress and sewn pillow top
- Bed head - upholstered
- Bedside drawers
- Blinds - Shangri La Silhouette roller blinds to port and starboard windows
- Day lounge - leather upholstered in Contemporary Style
- Drawer units - port and starboard
- Flooring - wool carpet (Action Back - Stone)
- Flooring ensuite - Karndean (shower base GRP)
- Full beam master
- Hanging locker - full height hanging locker to entrance (cedar lined)
- Hanging locker - half height forward hanging locker (cedar lined)
- LED ceiling lights
- Master ensuite - fresh water flush toilet, shower with automatic pump, frameless glass shower screen, opening port with cover, vanity with mirror, solidsurface bench top, towel rails, robe hooks and LED down lights
- Mirror - full height
- Panoramic hull windows with opening port lights
- Portside storage (**Black Edition**) into aft end of standard drawer sets, to include a pull out lid
- TV - 43" LED (fixed)
- Wall lights

---

# STANDARD SPECIFICATIONS

---

## FORWARD STATEROOM

- Bed - queen size, offset island berth with inner spring mattress, sewn pillow top and lift up storage. **Black Edition** lowered bed design with under bed set-up for future storage and charging of a stick vacuum
- Bed head - upholstered
- Bed side tables
- Deck hatch with blind
- Drawer unit to forward front cabin - **Black Edition** design
- Flooring - wool carpet (Action Back - Stone)
- Flooring ensuite - Karndean (shower base GRP)
- Hanging Locker- full height locker to starboard side
- Guest bathroom - shared with companionway - fresh water flush toilet, shower with automatic pump, frameless glass shower screen, vanity with mirror, LED down lights, solidsurface bench top, deck hatch with blind, towel rails and robe hooks
- LED ceiling lights
- Mirror - full height
- TV - 43" LED (fixed)
- Wall lights

## LOWER COCKPIT - ADVENTURE DECK

- Cockpit shower hot and cold
- Cockpit floodlights x 2 mounted to aft end of hardtop
- Dockside water fitting
- Lower cockpit entertainment unit - **Black Edition** designed with;
  - plate fridge
  - access door to lazarette
  - large Epicure stainless steel BBQ AC volt with safety switch (600 x 325) and controls on top
  - sink
  - GPO
- Manual folding swim ladder
- Storage lockers - double sized to port and starboard
- Teak laid decking
- Twin shore power inlets 2 x 16 amp

## STARBOARD CABIN

- Beds - twin single, side by side - **Black Edition** upgrade to manually slide together
- Blind - roller blind to starboard window
- Deck hatch with blind and integrated emergency escape ladder
- Flooring - wool carpet (Action Back - Stone)
- Hanging locker - full height
- LED ceiling lights
- Mirror - full height
- Panoramic hull window
- Wall lights

## UPPER COCKPIT

- Access hatch with steps to engine room
- Actuators - electric heavy duty actuators to euroboot
- Awning (white) - **Black Edition** designed awning to cover forward facing seat
- **Black Edition** larger designed cockpit module, set back on deck to increase upper cockpit floor space
- **Black Edition** designed forward facing seat with white cover
- LED lighting
- **Black Edition** designed fixed cockpit table to forward facing seat on stainless steel twin pedestals with white cover
- Fresh water tap
- LED lighting
- Rope lockers - port and starboard (**Black Edition** size)
- Teak laid decking to upper cockpit
- Transom gates - **Black Edition** (GRP) port and starboard gates to upper cockpit

---

# STANDARD SPECIFICATIONS

---

## GENERAL

- Boat hook
- **Black Edition** pull-out laundry drawer to companionway
- **Black Edition** upgraded headliner panels (Ocean Pebble) to the ceiling of the cockpit, flybridge balcony, flybridge and salon
- **Black Edition** bathroom chrome fittings
- Docking lines x 4
- Fenders x 4
- Flooring lazarette - Infinity vinyl to lazarette floor and steps
- Fresh water hose coil
- Hand held fire extinguishers 1kg x 3
- Owners pack
- Set of flares, life jackets and coastal safety gear
- Shore power leads x 2

## ADDITIONAL INCLUSIONS

- TVs - fit air antenna, cabling, GPO mounts & lifts for saloon & flybridge for dealer install of TVs. Factory to install master & forward stateroom wall mounted (AUS) TVs
- Apollo Entertainment System with premium Krix speakers and sub woofer to saloon
- Cockpit speakers - 2 x Krix speakers with fixed remote
- Flybridge (internal) speakers - 2 x Krix speakers, sub woofer and fixed remote
- Upgrade to Mood Lighting Package (interior and exterior)
- Dimmers to Mood Lighting zones
- Flybridge interior window covers, front & side triangle windows (black Breezeway)
- Flybridge Shangri La Silhouette roller blinds to flybridge port and starboard windows and rear door
- Panoramic sliding windows to flybridge
- Panoramic sliding windows to saloon
- Starboard Cabin - single beds to slide together to form a double bed
- Upgrade entire bathroom flooring to Solidsurface (shower / ensuite)
- Stainless steel cockpit rails - suitable for tying fenders
- Standard Soft Furnishings Package with TTDS (total 4hrs consultation time)
- Credit safety equipment - Export only
- Forward and aft hull windows (total 6)
- Additional port holes x 3 - starboard cabin x 1, master stateroom x 2 going forward on the port and starboard sides (total 6)

# OPTIONS

## ENGINE UPGRADES

Volvo D13 - 1000 mhp - TD	NET	<input type="checkbox"/>	\$ POA
Volvo D13 - 1000 mhp - ZF	NET	<input type="checkbox"/>	\$ POA
Scania DI13 - 900 mhp - TD	NET	<input type="checkbox"/>	\$ POA
Scania DI16 - 1150 mhp - TD	NET	<input type="checkbox"/>	\$ POA

## HELM

Engine controls - portside flybridge aft deck (deleting rubbish bin)	NET	<input type="checkbox"/>	\$12,305
Engine controls - port side cockpit	NET	<input type="checkbox"/>	\$12,305
Engine controls - Twin Disc / ZF	NET	<input type="checkbox"/>	\$19,140
Yacht Controller - dual band with hand held remote		<input type="checkbox"/>	\$26,335

## PAINT

Painted Hull - polyurethane - includes boot top	<input type="checkbox"/>		\$64,275
<input type="checkbox"/> non metallic <input type="checkbox"/> metallic			
Painted Hartop polyurethane - includes domes & masts in non-metallic	<input type="checkbox"/>		\$32,630
<input type="checkbox"/> non metallic <input type="checkbox"/> metallic			
Paint radar, domes & mast - Black (non-metallic)	<input type="checkbox"/>		\$3,380

## DAVITS

Foredeck - 350kg Compact Davit - 3 function Hydraulic (Slew, Luff & Extension) <i>will reduce your # of people on board by 4 people</i>	<input type="checkbox"/>	\$48,645
--	--------------------------	----------

## FORWARD DECK AND ENGINEERING

Forward facing sun lounge (bench seat) <b>Black Edition</b> design and cover	<input type="checkbox"/>	\$9,830
Sun bed <b>Black Edition</b> design and cover, will integrate with future tender install	<input type="checkbox"/>	\$11,210
Sun bed <b>Black Edition</b> design with folding back rest and cover	<input type="checkbox"/>	\$12,305

## WATER MAKERS

Idromar IDRO-MC2J 130 litres / hour Water maker with Sand Filter	<input type="checkbox"/>	\$36,405
Pre-fit for Dealer installed Watermaker: skin fitting, 240v GPO	<input type="checkbox"/>	\$POA

## PLATFORMS

Hydraulic teak laid swim platform (1.4 M / 4' 7")	<input type="checkbox"/>	\$70,330
Fixed teak laid swim platform (1.4 M / 4' 7")	<input type="checkbox"/>	\$ 22,365

## TROPICAL AIR UPGRADE

Add 12,000 BTU Air-conditioner to Saloon	<input type="checkbox"/>	\$11,625
--	--------------------------	----------



# OPTIONS

## LIGHTS

Underwater LED lights x 4 aft facing (blue) ☐ \$7,070

Underwater LED lights x 4 aft facing (white) ☐ \$7,070

## ELECTRICAL

Upgrade house & start batteries to AGM Full River ☐ \$9,045

Sat TV6 KVH ☐ \$19,655

TV6 Dummy Dome ☐ \$3,845

Seaview flybridge mast for radar and satellite TV ☐ \$5,455

Install owner supplied Starlink Marine Package which must incorporate a 25M Starlink cable ☐ \$3,245

or Install owner supplied 25M Starlink cable for future owner install of Starlink Marine Package ☐ \$1,230

Upgrade interior GPOs ONLY to International Multi Region GPOs ☐ POA

Additional Vimar AC / USB / USC charger outlet (details in NSE /CV) EACH ☐ \$770

1 x 32 amp dock with circuit breaker box to 2 x 16 amp inlets (boat end) lead ☐ \$1,915

1 x 32 amp dock, 3 phase to circuit breaker box and 2 x 32 amp inlets (boat end) lead. Includes 1 x 15 amp dock to 32 amp shorepower (boat end) lead ☐ \$3,045

## COVERS

Lower windsreen cover - select colour ☐ STD ☐ STD - White Stamoid or ☐ Black Breezeway

Aft flybridge black Breezeway fixed enclosure - 3 sides, roll up, incl. 1/4 panel clears ☐ \$13,545

Aft flybridge clear enclosure fixed 3 sides, roll up, incl. 1/4 panel clears ☐ \$ 15,915

Flybridge **Black Edition** 1/4 panel clears ☐ \$3,935

Flybridge **Black Edition** rear awning - select colour ☐ STD ☐ STD - white ☐ black

Cockpit black Breezeway enclosure - 3 sides, roll up, incl 1/4 panel clears ☐ \$14,295

Cockpit clear enclosure - 3 sides, roll-up incl. 1/4 panel clears ☐ \$16,665

Cockpit **Black Edition** 1/4 panel clears ☐ \$4,515

Cockpit **Black Edition** rear awning fixed - select colour ☐ STD ☐ STD - white ☐ black

Removable lower aft cockpit euro awning with stainless steel poles, including rod holders x 2 to swim platform ☐ \$6,420

# OPTIONS

## COCKPIT

Bi-fold doors to galley - can only change from STD sliding doors if L-shaped lounge to Upper Cockpit is not selected ☐ N/C

Upgrade STD forward facing lounge to a **Black Edition** U-Shape using removable Chaise Ottomans x 2 to form the U shape with white cover ☐ \$5,180

Upper cockpit lounge - **Black Edition** starboard L-shaped lounge seating with white cover ☐ \$15,160

Upper cockpit lounge - **Black Edition** port lounge seating with white cover ☐ \$9,985

Upper Cockpit Portside bar module - **Black Edition**; Three door wet bar with sink, rubbish bin, Solidsurface top and storage below. *Storage space to suit a selected option of a bar fridge and ice maker or storage* ☐ \$9,005

Bar Fridge to portside wetbar ☐ \$4,760

Icemaker to portside wetbar ☐ \$5,260

K'archer pressure cleaner, one outlet with hose to reach bow ☐ \$5,355

Rod holders x 2 to cockpit ☐ \$1,380

## LAZARETTE

Flooring lazarette - **Black Edition** finish - Infinity vinyl to flooring, steps and white Breezeway to skirting ☐ \$4,970

Rod holder storage to lazarette **Black Edition** ☐ \$585

## FLYBRIDGE

Electric sunroof to flybridge hardtop with blind ☐ \$26,145

Flybridge head; internal entry, toilet, window with blind, sink with hot & cold water and Solidsurface flooring ☐ \$38,755

Bar fridge to flybridge balcony bar module in lieu of storage ☐ \$4,760

Flybridge balcony **Black Edition** L-shaped seating to starboard side with white cover ☐ \$13,800

Flybridge balcony **Black Edition** L-shaped seating to port side with white cover ☐ \$13,800

Removable infill cushion to between the two L-shaped lounges on flybridge balcony to form a U-shaped with white cover ☐ \$1,990

Flybridge balcony table on stainless steel pedestal and base with white cover. *Can be installed to either the starboard or port selected L-shaped seating option EACH* ☐ \$4,360

Teak laid decking to flybridge exterior aft balcony ☐ \$19,425

Double fold out sofa bed to flybridge aft entertainment lounge (modify lounge - no longer L-shaped) ☐ \$6,295

Upgrade flybridge blinds to rechargeable battery operated electric roller blinds to the port and starboard windows and rear door ☐ \$3,345

Ottoman with storage EACH ☐ \$1,990

Ottoman - fold out table with storage EACH ☐ \$2,230

Rocket launchers x 6 to aft flybridge rail ☐ \$4,705

# OPTIONS

## SALOON AND GALLEY

Wine fridge to galley

Under stairs ☐ ☐ \$8,180  
(not when twin drawer fridge selected)

To island bench facing port side ☐

Twin drawer fridge under stairs - select combination

Fridge / Fridge ☐ \$6,980  
Freezer / Freezer ☐

Ottoman with storage EACH ☐ \$1,990

Ottoman - fold out table with storage EACH ☐ \$2,230

## OTHER

Bosch Washer / Dryer combo - lower companionway ☐ \$6,515

Bosch Washer - lower companionway ☐ \$5,015

Bosch Dryer - master entry ☐ \$3,840

Upgrade STD blinds to saloon and master stateroom to **Black Edition** rechargeable battery operated electric roller blinds ☐ \$4,855

Upgrade from STD to a custom soft furnishings package ☐ \$POA

## CABINS

Master Stateroom - Starboard side Option 1 - one bank of two drawers and a top slide out computer/ vanity with std day lounge ☐ \$820

Master Stateroom - Starboard side Option 2 - Two banks of three drawers, aft day lounge shortened ☐ \$6,030

Master Stateroom - Starboard side Option 3 - Three banks of three drawers in lieu of day lounge ☐ \$6,030

Master Stateroom - Starboard side Option 4 - Three banks of drawers - and a hollow section with slide out computer / vanity in lieu of day lounge ☐ \$6,030

Master Stateroom - Starboard side Option 5 - Full height hanging locker with two banks of two drawers in lieu of day lounge ☐ \$8,180

## TIMBER FINISHES

Enviro Walnut - Satin ☐ STD

Change STD Satin timber finish to;

- Enviro Teak - Satin ☐ ☐ N/C  
- Enviro Oak - Satin ☐

Change from a Satin to a Gloss finished

- Enviro Walnut - Gloss ☐ ☐ \$18,850  
- Enviro Teak - Gloss ☐  
- Enviro Oak - Gloss ☐

---

# OPTIONS

---

## BENCH TOPS

Solidsurface - Aspen	<input type="checkbox"/>	STD
----------------------	--------------------------	-----

Change STD bench top Solidsurface selection to;

- Solisurface Bianco	<input type="checkbox"/>	<input type="checkbox"/>	\$1,430
- Solidsurface Nebbia	<input type="checkbox"/>		
- Solidsurface Calacatta Neue	<input type="checkbox"/>		

## INTERNAL FLOORING

Karndean galley flooring selection

- Niveus	<input type="checkbox"/>		
- Birch	<input type="checkbox"/>	<input type="checkbox"/>	N/C
- Talpa	<input type="checkbox"/>		
- Marron Elm	<input type="checkbox"/>		

Karndean flooring to entire saloon in lieu of carpet	<input type="checkbox"/>	\$9,880
--	--------------------------	---------

Karndean flooring to internal flybridge in lieu of carpet	<input type="checkbox"/>	\$10,010
---	--------------------------	----------

Karndean flooring to all internal steps and companionway outside of cabins in lieu of carpet (note cabins must remain carpet)	<input type="checkbox"/>	\$10,580
--	--------------------------	----------









